

Specification:

- 1) Rating: 20 A 125 VAC; 15 A 250 VAC
- 2) Contact Resistance: 35 mW max.
- 3) Insulation Resistance: 500 VDC 100 MW min.
- 4) Dielectric strength: 1500 VAC, 1 minute
- 5) Operating temperature: -30°C ~ +80°C
- 6) Electric Life: 10000 cycles

RSI2011A3BK/WH

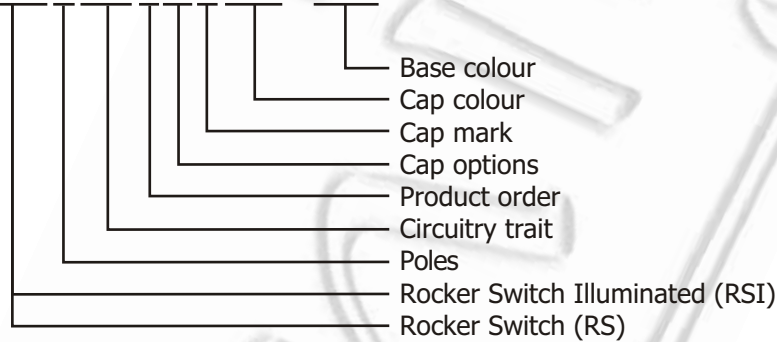

CIRCUITRY TRAIT

01	ON	-	OFF
11	(ON)	-	OFF
02	ON	-	ON
03	ON	OFF	ON
23	(ON)	OFF	(ON)

() indicates momentary

CAP COLOUR

RD	red
GN	green
OR	orange
BU	blue
WH	white
BK	black
YL	yellow

PROTECTIV CAP



RSC-09

CAP OPTIONS

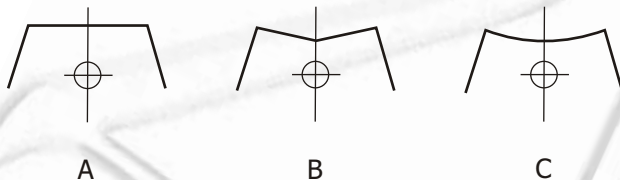

BASE COLOUR

WH white
GY gray
omitted when standard colour (black)

CAP MARKING

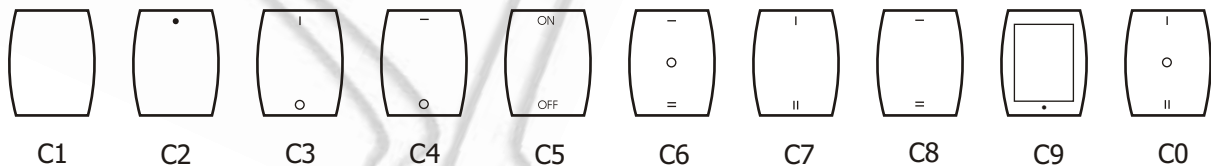

Ninigi



RSI2011A ON-OFF
RS2011A ON-OFF
 DPST 4P

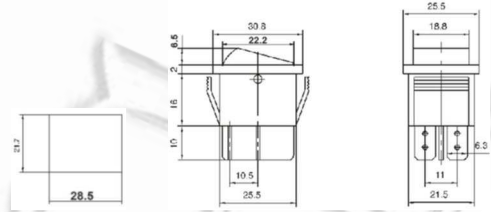

RSI2011B ON-OFF
RS2011B ON-OFF
 DPST 4P

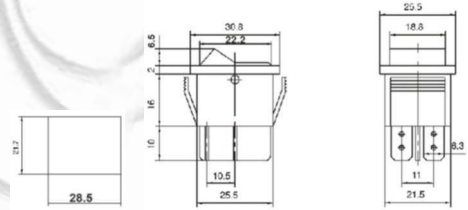

RSI2011C ON-OFF
RS2011C ON-OFF
 DPST 4P

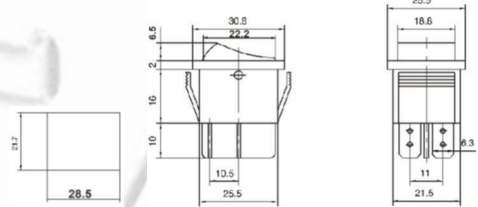

RSI2021A ON-ON
RSI2031A ON-OFF-ON
RS2021A ON-ON
RS2031A ON-OFF-ON
 DPDT 6P

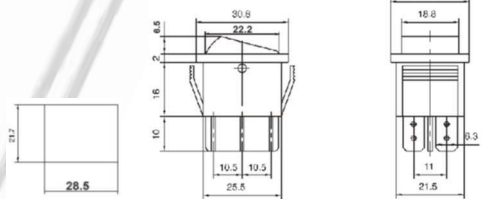

RSI2021B ON-ON
RSI2031B ON-OFF-ON
RS2021B ON-ON
RS2031B ON-OFF-ON
 DPDT 6P

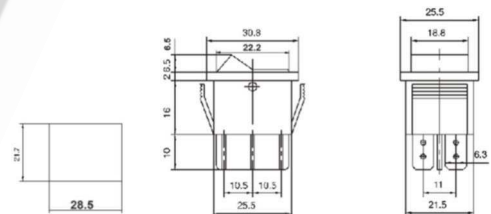

RSI2021C ON-ON
RSI2031C ON-OFF-ON
RS2021C ON-ON
RS2031C ON-OFF-ON
 DPDT 6P

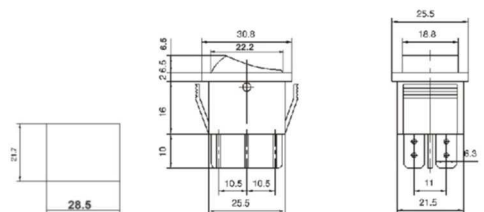

Ninigi



RSI2012A ON-OFF
RS2012A ON-OFF
 DPST 4P

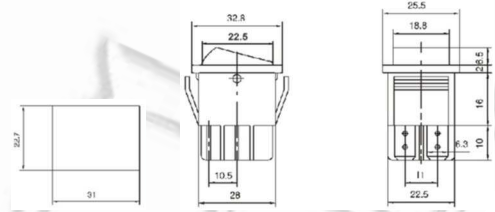

RSI2012B ON-OFF
RS2012B ON-OFF
 DPST 4P

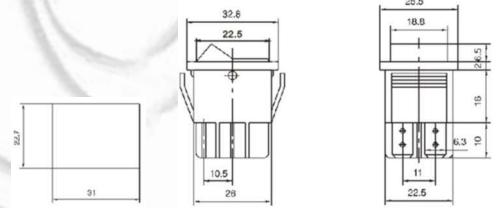

RSI2012C ON-OFF
RS2012C ON-OFF
 DPST 4P

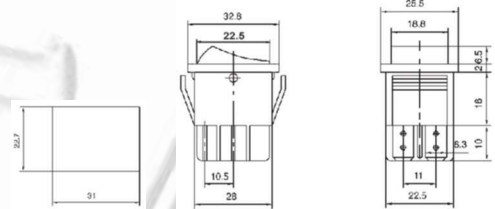

RSI2022A ON-ON
RS2022A ON-ON
 DPDT 6P

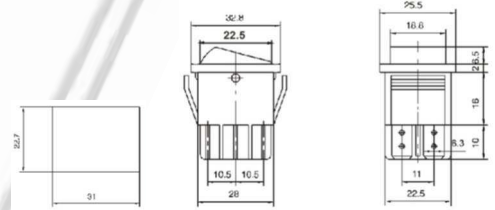

RSI2022B ON-ON
RS2022B ON-ON
 DPDT 6P

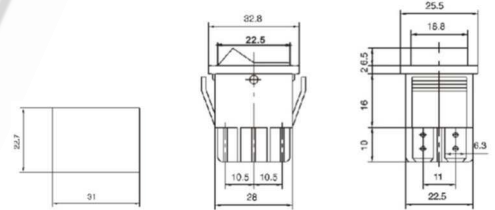

RSI2022C ON-ON
RS2022C ON-ON
 DPDT 6P

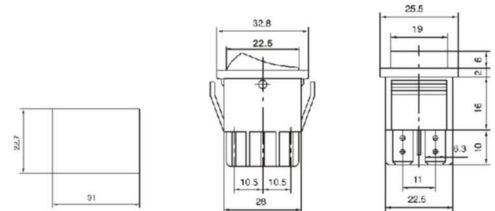

Ninigi



RSI2013A ON-OFF
RS2013A ON-OFF
 DPST 4P

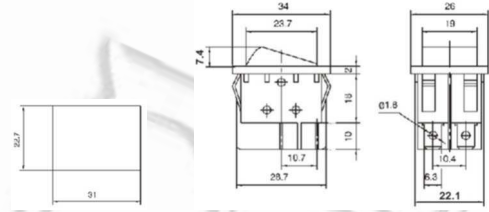

RSI2013C ON-OFF
RS2013C ON-OFF
RS2113C (ON)-OFF
 DPST 4P

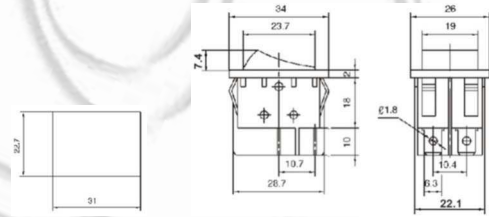

RSI2023A ON-ON
RS2023A ON-ON
 DPDT 6P

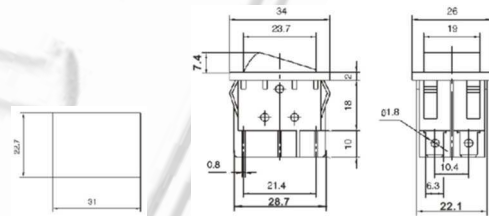

RSI2023C ON-ON
RS2023C ON-ON
 DPDT 6P

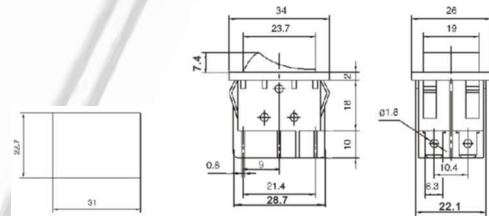

RS2014C ON-OFF
 DPST 4P

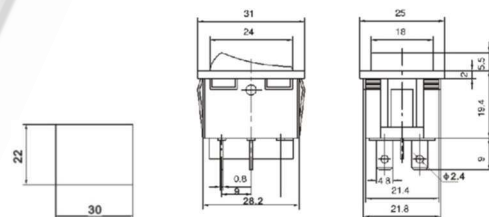

RSI2024C ON-ON
RS2034C ON-OFF-ON
RS2234C (ON)-OFF-(ON)
 DPDT 6P

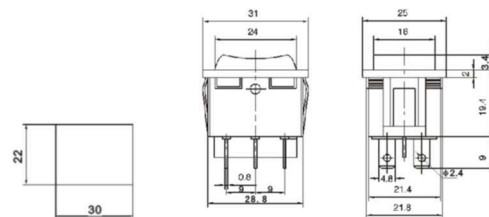

Ninigi



RS2025C ON-ON
RS2035C ON-OFF-ON
 6 A 125 VAC; 3 A 250 VAC
 DPDT 6P

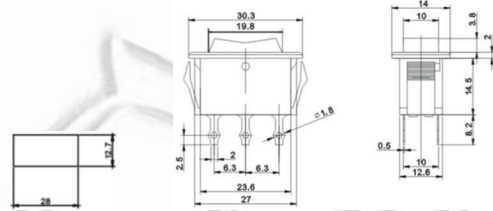

RS21011A ON-OFF
 DPST 4P

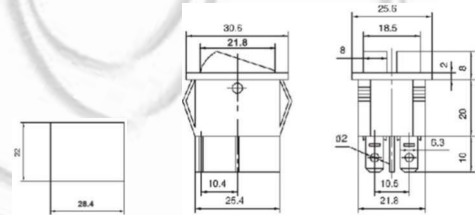

RS21011B ON-OFF
 DPST 4P

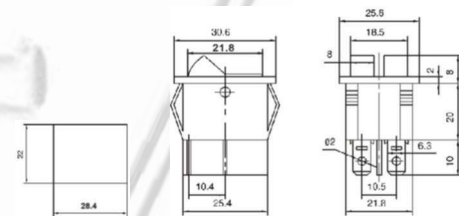

RS21011C ON-OFF
 DPST 4P

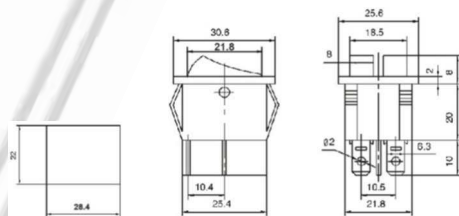

RSI21011A ON-OFF
 DPST 6P
RS21021A ON-ON
 DPDT 6P

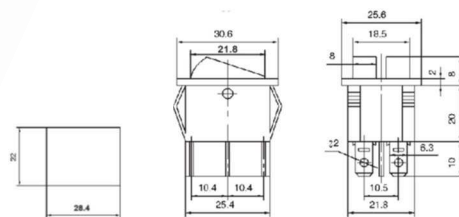

RSI21011B ON-OFF
 DPST 6P
RS21021B ON-ON
 DPDT 6P

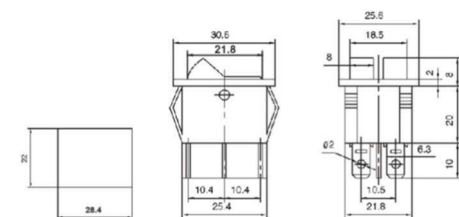

Ninigi



RSI21011C ON-OFF
DPST 6P
RS21021C ON-ON
DPDT 6P

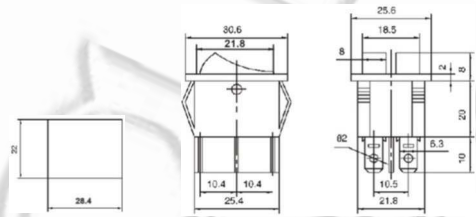

RSI2101E1C ON-OFF
DPST 6P

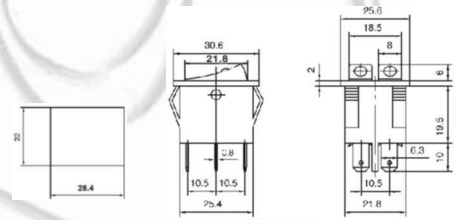

RSI21013C ON-OFF
DPST 6P

