

SPECIFICATION :

- 1. Circuit: 2P **A: OFF-(ON)**
C: ON-(OFF)
- 2. Rating: 1A 125VAC/250VAC .
- 3. Contact Resistance : 20m Max.
- 4. Insulation Resistance: DC 500V 100MOHMS.
- 5. Dielectric Strength: AC 1000V 1 minute

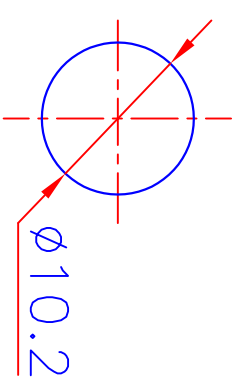
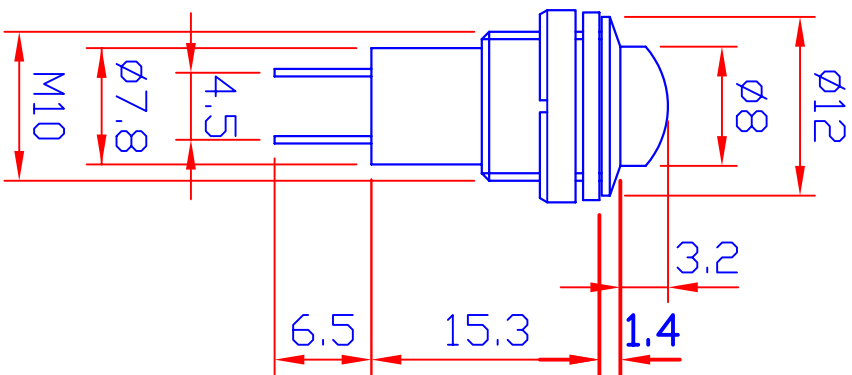

PANEL CUT-OUT

NO.	DESCRIPTION	QTY	MATERIAL	SPECIFICATION	REMARK
DRAW BY	周佩君	072007	SCALE	2 : 1	ITEM NO. 316
DEGN BY			UNIT	MM	TITLE PUSH-BUTTON SWITCH
APPD BY					
同利企業有限公司 TELE LONG ENTERPRISE CO.,LTD TEL. 886-6-2530201				DRAWING NO. 316-CN16-A	

DATE

DRAWG BY

REVISED

(CS316)

E-mail: rayyang@seed.net.tw

FAX. 886-6-2530232